

Aquaglide

1 North shore Drive White Salmon, WA 98672 phone 509-493-4938 fax 509-493-4966 email info@aquaglide.net

TO WAIVE ANY AND ALL CLAIMS that you have or may in the future have against Aquaglide, Inc., North Sports Inc., its distributors and dealers resulting from use of the Aquaglide and any of its components.

RELEASE AND WAIVER OF CLAIMS AGREEMENT: In consideration of the sale of the product to you, you hereby agree to the fullest extent permitted by law, as follows:

ASSUMPTION OF RISK: Use of the Aquaglide and any of its components involves certain inherent risks, dangers and hazards which can result in serious personal injury and death. In using the product you freely agree to assume and accept any and all known and unknown risks of injury while using this equipment. The risks inherent in the sport can be greatly reduced by abiding by the Warning Guidelines listed in this Owner's Manual and by using common sense.

By opening and assembling this product, you are agreeing (1) to be bound to the terms set forth below; and (2) to require anyone using this product to be bound by such terms. If you are unwilling to be bound by these terms, return this product (before use) for a full refund.



NOTICE! - Release of Liability, Claim Waiver and Assumption of Risk Agreement

Owners Manual



Stop! Read this manual carefully before using this product!

It is the owners responsibility to read the owners manual and instruct all users in the safe operation of this product. By inflating this product you hereby agree to the Release of Liability, Claim Waiver and Assumption of Risk Agreement on the back of this manual. Please read this manual prior to inflating and using this product and keep for future reference. As with any action sport, reckless-ness, inexperience, misuse or neglect of the equipment may result in serious injury or death.

For questions regarding assembly, parts or warranty, contact our customer service department directly at 509-493-4938, option 1 (8am to 5pm, PST Monday-Friday) or access product information at www.aquaglide.net, or email to info@aquaglide.net

Warranty REGISTER ONLINE: www.aquaglide.net/registration_form.cfm

North Sports warrants Aquaglide products to be free of defects in material or workmanship to the original purchaser for a period of one year from date of purchase. This warranty is subject to the following limitations:

1. The warranty is valid only when the warranty card is properly filled out online at www.aquaglide.net within (30) days from date of purchase.
2. Warranty is valid only when the Aquaglide product is used for normal recreational activities, and does not cover use in schools or rental operations.
3. North Sports will make the final warranty determination which may require inspection and/or photos of the product which clearly show defect(s). We require the above to be sent to North Sports postage prepaid or by email to warranty@north-sports.com.
4. If a product is deemed to be defective by North Sports, the warranty covers the repair or replacement of the defective product only. North Sports will not be responsible for any costs, losses or damages incurred as a result of loss of product.
5. This warranty does not cover damage caused by misuse, abuse, neglect or normal wear and tear including, but not limited to, punctures, dragging the product over the ground, damage due to excessive sun exposure or seam failure due to over inflation in the sun, damage caused by improper handling and

storage, damage caused by use in waves or shore break and damage caused by anything other than defects in materials and workmanship.

6. This warranty is voided if any unauthorized repair, change or modification has been made to any part of the equipment. Authorization for such must come in writing from North Sports.
7. The warranty for any repaired or replacement equipment is good from the date of the original purchase only.
8. Any warranty claims must be accompanied by the original purchase receipt. The name of the retailer and date of purchase must be clear and legible.
9. There are no warranties which extend beyond the warranty specified here.

for more information go to our website at
www.Aquaglide.net

ENTIRE AGREEMENT: In entering into this Agreement, you are not relying upon any oral or written representations other than what is set forth in this agreement and the Aquaglide Owner's Manual.

BINDING EFFECT OF AGREEMENT: In the event of your death or incapacity, this Agreement shall be effective and binding upon your heirs, next of kin, executors, administrators, assigns and representatives.

ARBITRATION: In further consideration of the sale to you of this product and any of its components, you hereby agree to submit to binding arbitration any and all claims which you believe you may have against North Sports arising from the use of any Aquaglide equipment or products. The arbitration shall be pursuant to the rules of the American Arbitration Association. Arbitration shall be commenced within (1) year from the date on which any alleged claim first arose. Further, the arbitration shall be held in White Salmon, Washington unless otherwise mutually agreed to by all parties. The submission to the American Arbitration Association shall be unlimited and the arbitration award may be enforced by any Court of competent jurisdiction.

TO RELEASE North Sports, Inc. and Aquaglide, Inc. from any and all liability for any loss, damage, injury or expense that you or any users of this product may suffer, or that your next of kin may suffer, as a result of the use of this product, due to any cause whatsoever, including negligence or breach of contract on the part of North Sports in the design or manufacture of this product and any of its components.

Warning Softpack

Use of this product and participation in the sport involves inherent risks of injury or death. Watersports are fun and challenging but involve inherent risks of injury or death. To increase your enjoyment of the sport and to reduce your risks, use common sense and follow these rules:

- **Not recommended for children under six years of age.**
- **This product should never be used by children except under adult supervision.**
- **This is not a personal floatation device.**
- **Always wear a U.S. Coast Guard approved Type III (PFD) vest.**
- **Do not attempt or allow somersaults.**
- **Landing on the head or neck can cause serious injury, paralysis or death.**
- **Do not dive or slide off head first or swim under this product.**
- **Not for storage of glass, or any breakable materials.**
- **Anchor in at least 8 feet of water.**
- **Do not use in residential pools. In commercial pool, keep 3 meter (10 ft) clearance on all sides; in open water, keep 4.5 meter (15 ft) clearance on all sides.**
- **Do not use under the influence of alcohol or drugs.**
- **Read Operator's Manual before use.**

THIS PRODUCT IS DESIGNED EXCLUSIVELY FOR USE ON WATER, IN COMBINATION WITH AN AQUAGLIDE BASE PLATFORM.

Before you start:

- Familiarize yourself with all applicable federal, state and local laws, the risks inherent in the sport and the proper use of the equipment.
- Know the waterways and area of use.

Please contact us if you have any questions on the proper selection, function, or safe use of this product.

Aquaglide

Product Instructions and Warnings

Using the Aquaglide Softpack, as with any action sport or recreational activity involving motion, involves risk of injury. Improper use of the Softpack, including reckless and/or careless behavior, neglect and/or misuse of the equipment, and/or inadequate supervision of children and others using the Softpack, can result in serious personal injury or death.

Read and understand all instructions and warnings in the owner's manual and printed on the product. Always act responsibly, provide proper supervision for children and others, and make sure all users of this product are in good physical condition.

It is the owner's responsibility to inform all users of the product safety rules and warnings printed on the product and in the owner's manual. Do not use this product unless you are fully aware of and willing to accept these risks and responsibilities.

To reduce the risk of injury or death, follow these guidelines:

- Softpack must be carefully secured to an Aquapark base platform before use. Using the Softpack without an appropriate base platform makes the Softpack unstable, and can be dangerous.
- Take all reasonable precautions in positioning and anchoring an Aquapark system.
- Scout the area before use to avoid any debris or obstacles that might present a safety hazard.
- Never attempt jumps or dangerous tricks.
- Know your own limits. Stop when you are tired. Act responsibly. Be in good physical condition and be cautious in your use of this or any other action sport product.
- Check the Softpack and platform connections for frays, cuts, sharp edges, knots, or wear before each use. Such conditions may lead to breaks and/or unsafe situations.
- PVC tube is subject to deterioration when exposed to direct sunlight. The life of the product will be extended when stored away from sunlight.
- Do not add hardware or attachments that are not supplied by the manufacturer.
- Softpack chamber is designed to hold ice or freezer packs along with beverages for day use.
- Use only Aluminum or Plastic containers that will not break. Do not place glass, or any other fragile material in Softpack chamber, as any motion could cause breakage, damage to product, personal injury, or death.
- After use, completely drain and dry storage compartment.

Proper inflation

Proper inflation is the key to optimum performance and durability of this product. If the tube is under inflated, damage can occur to the tube. Use caution and do not over-inflate above 1.4 psi. **When not in use**, be sure to remove some air from the tube and move the tube to a shaded location. Exposure to direct sunlight heats the tube and causes the air inside to expand, causing serious damage to the seams and I-beams.

Rapid Inflate Valve Inflating – Unscrew the cap and insert the pump fitting into the valve. Be sure to open the flap at the base of the valve. Remove the pump fitting after filling completely and make sure the black flap is seated securely closing the valve. If the flap is not seated, pull red tab to close valve. Replace the cap. **Deflating** – Unscrew the cap and use a dull object to hold the flap open while the product deflates. Replace the cap for storage.

Softpack Owners Manual

Assembly Instructions

Lay the product out on a flat surface without sharp objects that could puncture the PVC bladder or cover. Make sure the inside PVC bladder is unfolded and the valves are in the correct position, aligned with the cover valve openings.

Inflate the outer chamber first, then the inside chamber. This prevents excessive stress on the center I-Beams. Inflate the product to about 50% full. If your product has a cover, re-check to make sure it is correctly aligned with the PVC bladder and valves. After the cover is aligned with the PVC bladder inflate the chambers to 100% starting with the outer chamber

DO NOT DRAG the product into the water. Carry the Aquaglide product to avoid wear on the cover and possible punctures of the PVC bladder.

Anchoring Instructions

Softpack must be carefully secured to an Aquapark base platform before use. Using the Softpack without an appropriate base platform can be dangerous. Anchoring system should be applied to the base platform, and not directly to Softpack. Follow anchoring instructions for the appropriate base platform. Anchor in at least 8' of water

Maintaining Proper Inflation

It is important to monitor the amount of air in your Aquaglide product as heat will cause the bladder to expand, possibly damaging seams or I-beams. If you leave a full tube sitting in the sun for any length of time it will expand. Either store it in the shade or let some air out. Don't leave your product on the beach, dock or boat full of air! If the product is stored out of the sun in a cool place, you may need to add some air. Check and adjust the inflation level each time you use your product for maximum performance and enjoyment.

Storage

Allow the product to dry completely to prevent mildew. If using in salt water, rinse the product with fresh water prior to drying. Drain Softpack by tipping upside down, and/ or by bailing with a small container. Allow to dry completely before storing. Once dry, release all of the air from the chamber(s) and fold the product. It is best to store the product inside a warm area during cold weather. Do not expose to freezing temperatures, as it can damage the material and cracks can occur in the PVC bladder.

Troubleshooting Guide

Product won't hold air. Remove and re-install valve to make sure it is installed properly. Add some air if you suspect the product was not inflated fully. If necessary to repair a hole in the PVC bladder, use the PVC Repair Guide in this manual.

Valve is leaking: Make sure that the valve is screwed into the threads correctly. Valve and cap must be screwed down tightly.

Bladder does not get firm: Your air pump may not produce enough pressure to completely fill the bladder. Top off your inflatable as necessary with an Aquaglide double action hand or foot pump.

PVC Hull Repair Guide

The Aquaglide bladder is constructed of high quality PVC. Every hull is inflated at the factory and tested for 12 hours before shipping to insure reliability. PVC is not puncture proof, and leaks can occur. Often, leaks in the hull are caused by the valves not being tightly secured. Always test this before assuming a repair is necessary.

This product comes with a small repair kit that is sufficient to fix most small punctures. You can also purchase PVC patch materials and instructions at your marine dealer, or contact North Sports for more information.

Materials and Tools Needed

- Aquaglide repair kit
- A sponge and Soapy water
- Paper towels
- A small square of 220-grit sandpaper or similar
- Scissors
- Duct tape
- A piece of the vinyl repair material large enough to extend at least 1.2 cm (1 inch) to either side and beyond each end of the hole or tear

Repairing PVC Bladder

- Locate the problem area by inflating the PVC bladder and listening for the leak. If you do not hear the leak, wipe down suspect areas liberally - the entire bladder if necessary - with a sponge soaked in soapy water. The location of the leak will become apparent when the air exiting the PVC bladder makes the soapy water bubble.
- Dry the area around the hole, taking care not to lose its location. Mark a 4-cm (about 1.5-inch) diameter circle around the hole with a felt tip pen, and make a dot on the hole itself.
- Deflate the bladder and prepare the surface. Place the bladder flat, with no wrinkles in the patch area. Using 220-grit sandpaper, lightly sand the area 1 inch around the hole or tear. Blow away dust. Clean the area to be repaired with a solvent such as acetone and let dry. Do not touch this area with your fingers; any oil from your finger may cause the patch to fail.
- For small holes, cut the piece of vinyl repair material into a circle about 2.5 cm (1 inch) in diameter and lightly sand one side of this patch with the sandpaper and clean with solvent.
- For large tears, cut a piece of Duct tape and place inside the hull with the sticky side up, folding the edges of the tear onto the tape so that the boat retains it's original shape and that the edges of the tear are unwrinkled, horizontal and adjacent each other. Using scissors cut the piece of vinyl repair material into a shape that will extend at least 2.5 cm (1 inch) to either side and beyond each end of the tear and lightly sand one side of this patch with the sandpaper, and clean with solvent.
- Use the glue from the supplied repair kit, or other glues designed for PVC to make the repair. Make sure to follow the instructions on the glue. There are several types of glue, so carefully read and follow the instructions on the glue you are using.
- Allow repair to dry in level position according to the glue instructions. Inflate the bladder to 25%-50% and leave overnight to insure that the repair is sound and all holes have been patched.
- Roll up the Bladder lengthwise so that the valves will align with the valve openings and insert the bladder back inside the cover.

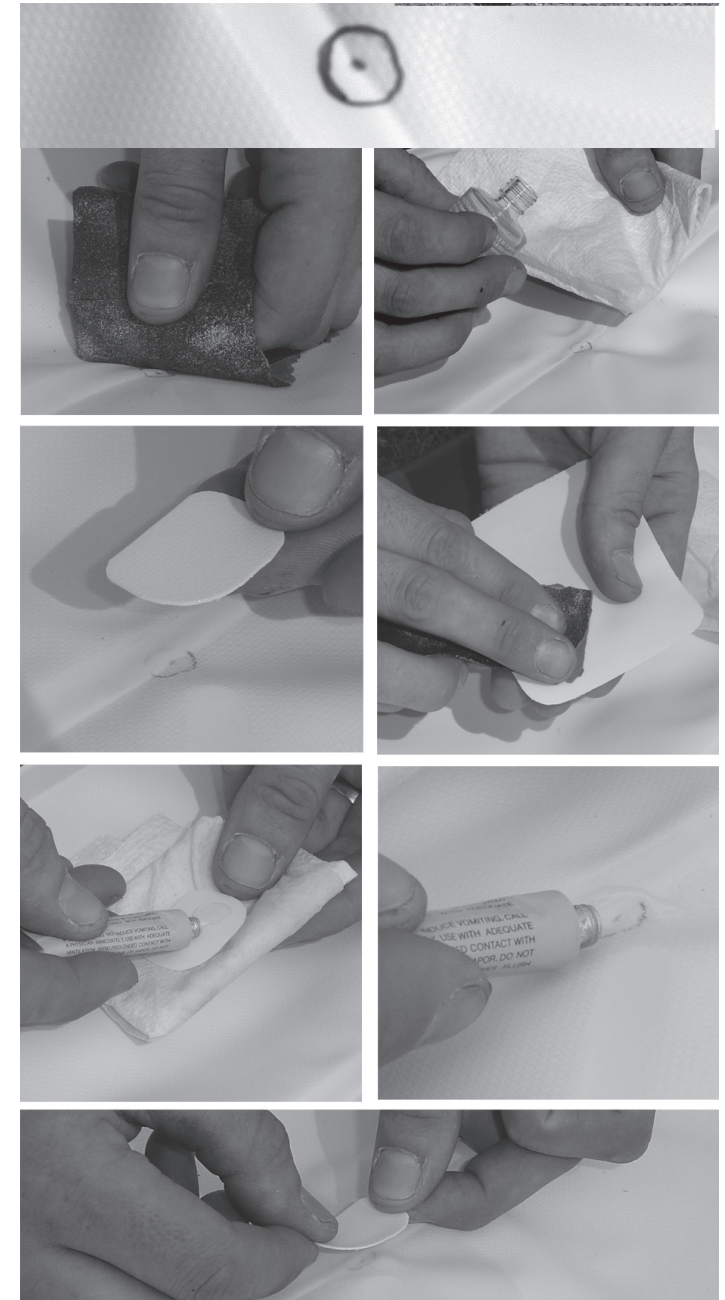

for more information go to our website at

www.Aquaglide.net